

PROJECT

RESIDENTIAL DEVELOPMENT CONTAINING PARTIALLY G+28 AND PARTIALLY G+25 AT PREMISES NO 561 BONHOOGHLY ARABLE LAND HOLDING NO 4 -(OLD)

SITE COORDINATES

22 38 40.31N 88 22 52.89E,

22 38 45.34N 88 22 53.33E,

22 38 39.59N 88 23 03.26E,

22 38 44.29N 88 23 03.26E.

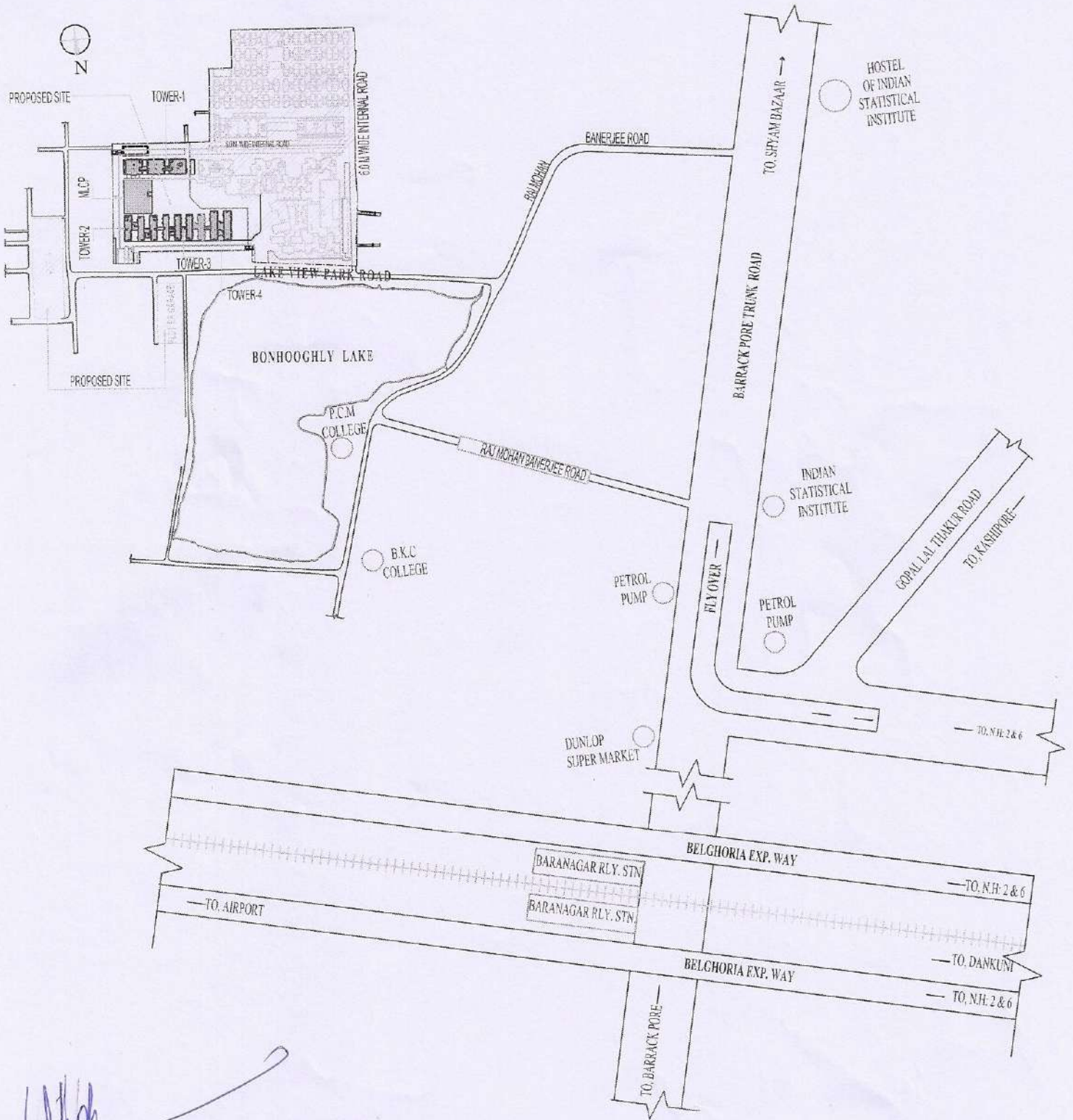

*[Signature]*  
**MALAY KUMAR GHOSH**  
Regn. No. CA/92/14854  
35A, Dr. Sarat Banerjee Road  
Kolkata - 700 029